

C&C

Cables & Chains

C & C INTERNATIONAL TRADING PTE LTD

One-stop ropes and rigging gears supply centre





C & C INTERNATIONAL TRADING PTE LTD

One-stop ropes and rigging gears supply centre

C & C has been the specialist in wire ropes, rigging gears and ship supply in Asia-Pacific for more than 20 years. We have grown from a small rigging and supply shop into a modern enterprise with a reputation for quality products and services.

Based on our extensive experience in servicing the shipbuilding, ship supply, offshore, logistics, port and construction industries, we have built up a wide range of products that includes wire ropes, high performance fiber ropes, anchors and chains, etc. Together with our constant investment in new technologies and capabilities, we have garnered a substantial track record from the conclusion of numerous projects and services.

We use our growing reputation to encourage ourselves to exceed our limits by giving our customers more than they expect. We are focused upon ensuring that we are an efficient supplier of the highest quality products and services.

Looking into the future, we are constantly striving to build long lasting ties based on mutual trust between vendors, ourselves and our customers.

OUR MISSION STATEMENT

Our company aims to be a global leader in the markets we serve. Driven by dynamic leadership and professional workforce, we aim to provide the highest quality products and services through our dedication and continuous innovation.

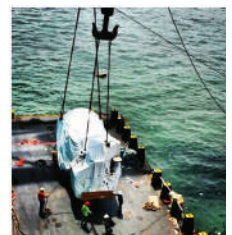

Marine & Offshore

Stockist for premium brands of steel wire ropes for construction, marine and offshore industries.

Stockist for premium brands of nylon, multi-filament, polyester mixed, Dyneema® and many other types of synthetic and natural fiber ropes that includes cotton and Manila Ropes.

Manufacturer of lifting wire rope slings and pennants such as heavy-lift slings and grommets. Customized selections manufactured to international standards inclusive of 3rd party certified load test certifications.

Fabrication of all sorts of fiber rope netting and ladder such as gangway nets, scramble nets, heli-deck nets, embarkation ladder, etc.

Stockist of quality rigging and lifting gears like shackles, hooks, chain and lever hoists, masterlinks, sleeves, webbing slings, chain slings, snatch blocks, etc.

Stockist of quality marine deck equipment, winches and fenders of various sizes.

Stockist of quality anchors, anchor chains and fittings of various sizes.

One stop load testing centre for certification and re-certification by competent professional engineers.

Professional marine and offshore installations for anchors, anchor chains and wire rope removal/ installation services by qualified riggers.



**WIRES
ROPES
& SLINGS**



OUR PRODUCTS AND SERVICES

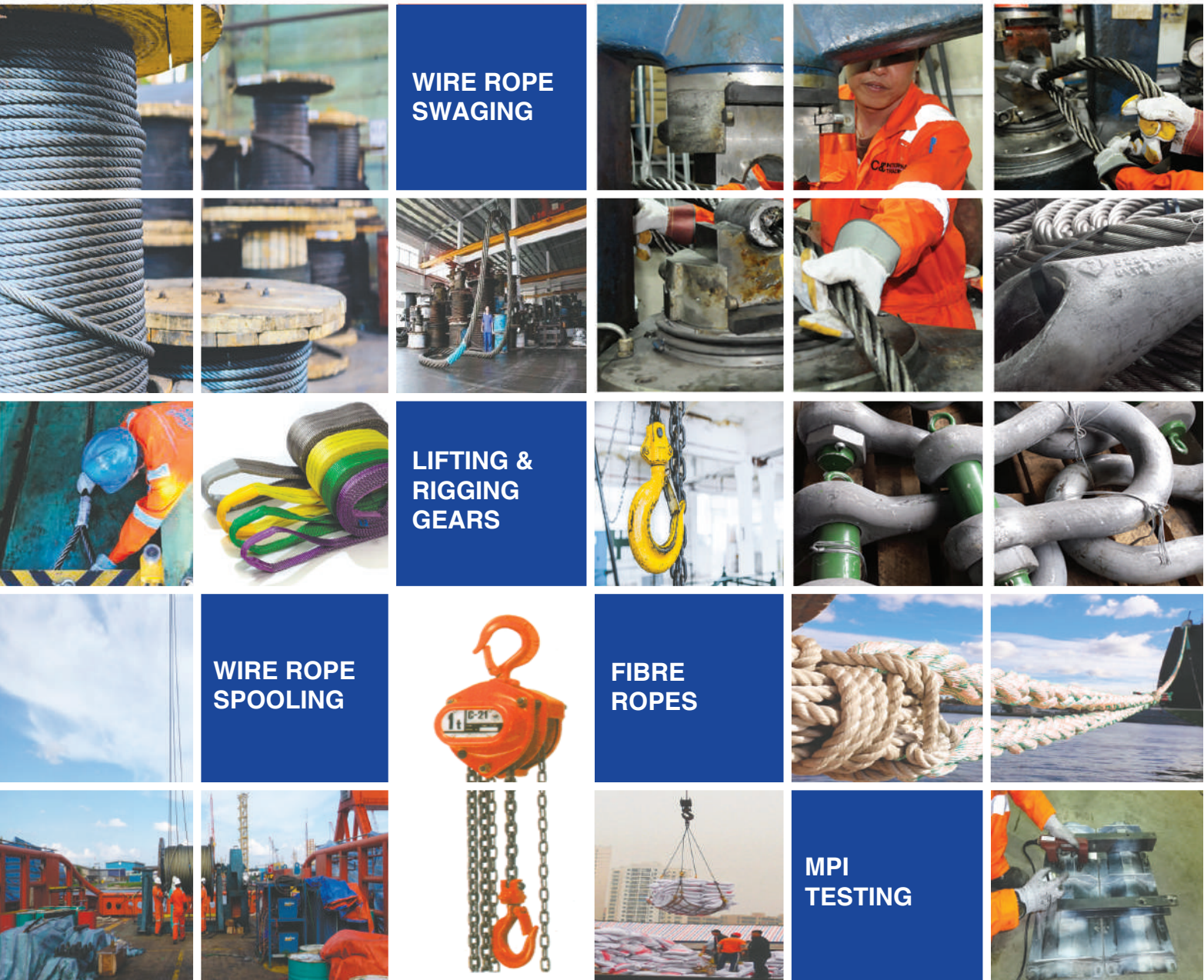

ROPES & RIGGING GEARS SPECIALIST SINCE 1995

1. CONSTRUCTION OF WIRE ROPE

The design of a rope is determined by:

STRAND CONSTRUCTION

The number and arrangement of wires in each strand

ROPE CONSTRUCTION

The number and arrangement of strands in each rope

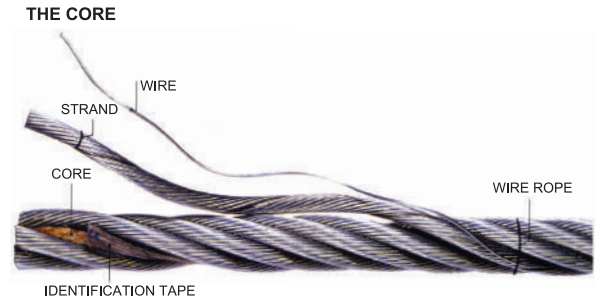

2. GRADES OF WIRE ROPE

Wire ropes are made of steel wires classified into following tensile strength grades to meet various requirements according to the applications.

- Grade 135 kg/mm²** : Special grade to meet requirement of hoisting ropes on traction elevators
- Grade 150/160 kg/mm²** : Galvanized wires coated with zinc through hot dip process for protection from corrosion
- Grade 165 kg/mm²** : Ungalvanized and drawn galvanized wires for general purpose wire ropes
- Grade 180 kg/mm²** : Ungalvanized high tensile grade wires for general purpose wire ropes
- Grade 195 kg/mm²** : Extra high tensile grade is used in the manufacture of wire rope where ultimate breaking strength is required

POINT CONTACT LAY ROPE

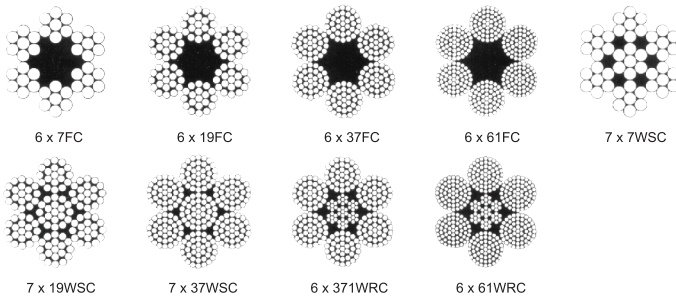

MARINE ROPE

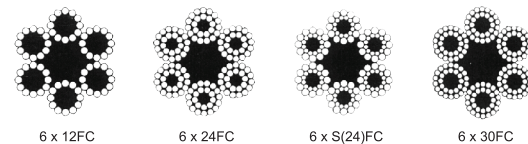

LINEAR CONTACT LAY ROPE 6x19 CLASS

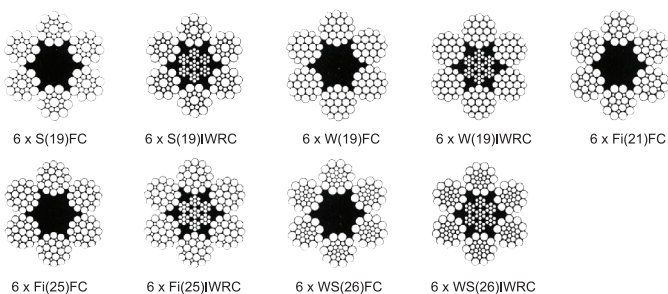

NON-ROTATING ROPE

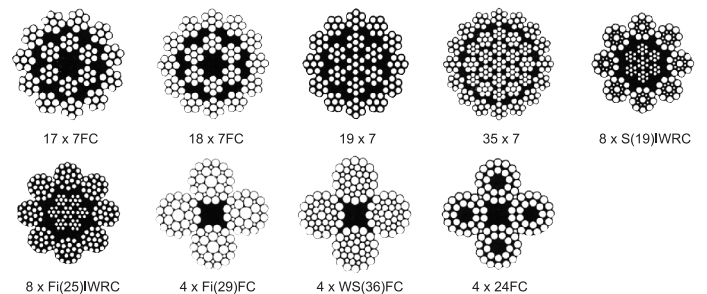

3. ARRANGEMENT OF WIRE ROPE

Right lay : Clockwise

Left lay : Counter-clockwise

Regular lay : Wires in strands are laid in the opposite direction of the strands and are parallel to the rope axis

Ropes with regular lay are easy to use and have higher resistance to crushing than those with lang lay

Wires are laid in the same direction as the strands of the rope, and in an angle to the rope axis

Lang lay : Longer lengths of the individual wires are exposed creating higher resistance to wear and improved flexibility

Lang lay ropes should only be used where both rope ends are "fixed" and therefore, should not be used with a swivel type terminal

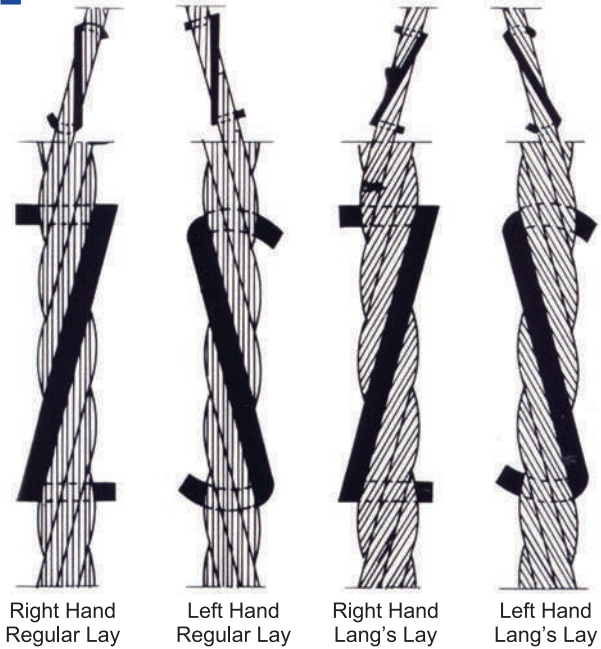

LINEAR CONTACT LAY ROPE 6x37 CLASS

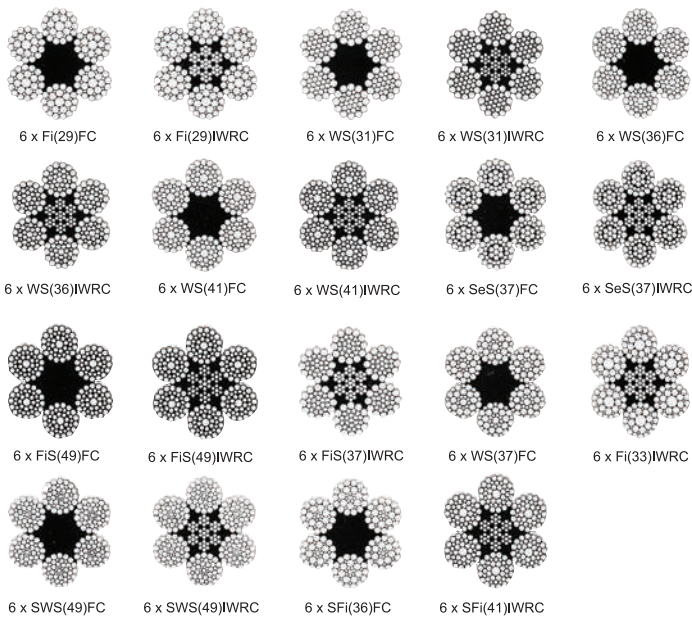

ELEVATOR ROPE

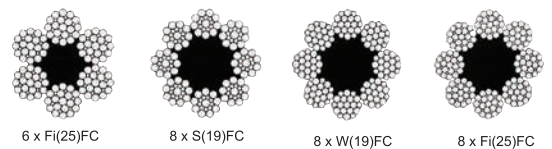

STAINLESS STEEL

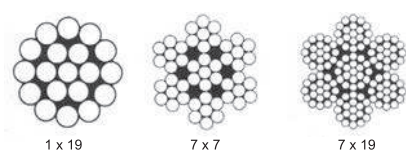

PVC-COATED (Galvanized and Stainless Steel)

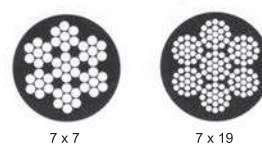

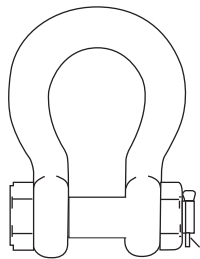

2130

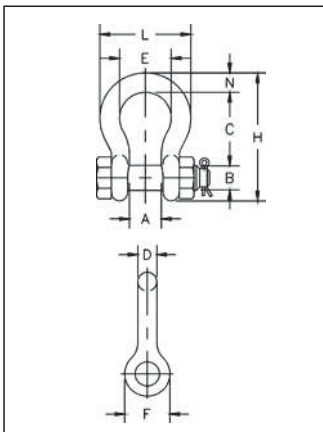

BOLT TYPE ANCHOR SHACKLES

Nominal Size (inch)	Working Load Limit (ton)	Weight Each (lbs)	Dimensions (inch)									Tolerance +/-	
			A	B	C	D	E	F	H	L	N	C	A
3/16	1/3 ‡	.06	.38	.25	.88	.19	.60	.56	1.47	.98	.19	.06	.06
1/4	1/2	.11	.47	.31	1.13	.25	.78	.61	1.84	1.28	.25	.06	.06
5/16	3/4	.22	.53	.38	1.22	.31	.84	.75	2.09	1.47	.31	.06	.06
3/8	1	.33	.66	.44	1.44	.38	1.03	.91	2.49	1.78	.38	.13	.06
7/16	1-1/2	.49	.75	.50	1.69	.44	1.16	1.06	2.91	2.03	.44	.13	.06
1/2	2	.79	.81	.64	1.88	.50	1.31	1.19	3.28	2.31	.50	.13	.06
5/8	3-1/4	1.68	1.06	.77	2.38	.63	1.69	1.50	4.19	2.94	.69	.13	.06
3/4	4-3/4	2.72	1.25	.89	2.81	.75	2.00	1.81	4.97	3.50	.81	.25	.06
7/8	6-1/2	3.95	1.44	1.02	3.31	.88	2.28	2.09	5.83	4.03	.97	.25	.06
1	8-1/2	5.66	1.69	1.15	3.75	1.00	2.69	2.38	6.56	4.69	1.06	.25	.06
1-1/8	9-1/2	8.27	1.81	1.25	4.25	1.13	2.91	2.69	7.47	5.16	1.25	.25	.06
1-1/4	12	11.71	2.03	1.40	4.69	1.29	3.25	3.00	8.25	5.75	1.38	.25	.06
1-3/8	13-1/2	15.83	2.25	1.53	5.25	1.42	3.63	3.31	9.16	6.38	1.50	.25	.13
1-1/2	17	19.00	2.38	1.66	5.75	1.53	3.88	3.63	10.00	6.88	1.62	.25	.13
1-3/4	25	33.91	2.88	2.04	7.00	1.84	5.00	4.19	12.34	8.80	2.25	.25	.13
2	35	52.25	3.25	2.30	7.75	2.08	5.75	4.81	13.68	10.15	2.40	.25	.13
2-1/2	55	98.25	4.13	2.80	10.50	2.71	7.25	5.69	17.90	12.75	3.13	.25	.25
3	† 85	154.00	5.00	3.30	13.00	3.12	7.88	6.50	21.50	14.62	3.62	.25	.25
3-1/2	† 120 ‡	265.00	5.25	3.76	14.63	3.62	9.00	8.00	24.88	17.02	4.38	.25	.25
4	† 150 ‡	338.00	5.50	4.26	14.50	4.00	10.00	9.00	25.68	18.00	4.56	.25	.25

US Specifications

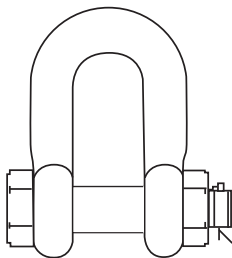

2150

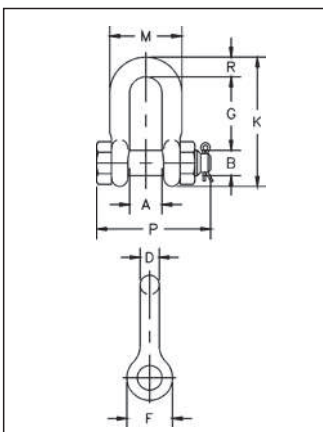

BOLT TYPE CHAIN SHACKLES

Nominal Size (inch)	Working Load Limit (ton)	Weight Each (lbs)	Dimensions (inch)									Tolerance +/-	
			A	B	D	F	G	K	M	P	R	G	A
1/4	1/2	.13	.47	.31	.25	.62	.91	1.59	.97	1.56	.25	.06	.06
5/16	3/4	.23	.53	.38	.31	.75	1.07	1.91	1.15	1.82	.31	.06	.06
3/8	1	.33	.66	.44	.38	.92	1.28	2.31	1.42	2.17	.38	.13	.06
7/16	1-1/2	.49	.75	.50	.44	1.06	1.48	2.67	1.63	2.51	.44	.13	.06
1/2	2	.75	.81	.64	.50	1.18	1.66	3.03	1.81	2.80	.50	.13	.06
5/8	3-1/4	1.47	1.06	.77	.63	1.50	2.04	3.76	2.32	3.56	.63	.13	.06
3/4	4-3/4	2.52	1.25	.89	.75	1.81	2.40	4.53	2.75	4.15	.81	.25	.06
7/8	6-1/2	3.85	1.44	1.02	.88	2.10	2.86	5.33	3.20	4.82	.97	.25	.06
1	8-1/2	5.55	1.69	1.15	1.00	2.38	3.24	5.94	3.69	5.39	1.00	.25	.06
1-1/8	9-1/2	7.60	1.81	1.25	1.13	2.68	3.61	6.78	4.07	5.90	1.25	.25	.06
1-1/4	12	10.81	2.03	1.40	1.25	3.00	3.97	7.50	4.53	6.69	1.38	.25	.06
1-3/8	13-1/2	13.75	2.25	1.53	1.38	3.31	4.43	8.28	5.01	7.21	1.50	.25	.13
1-1/2	17	18.50	2.38	1.66	1.50	3.62	4.87	9.05	5.38	7.73	1.62	.25	.13
1-3/4	25	31.40	2.88	2.04	1.75	4.19	5.82	10.97	6.38	9.33	2.12	.25	.13
2	35	46.75	3.25	2.30	2.10	5.00	6.82	12.74	7.25	10.41	2.36	.25	.13
2-1/2	55	85.00	4.12	2.80	2.63	5.68	8.07	14.85	9.38	13.58	2.63	.25	.25
3	† 85	124.25	5.00	3.25	3.00	6.50	8.56	16.87	11.00	15.13	3.50	.25	.25

US Specifications

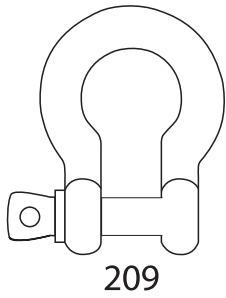

SCREW PIN ANCHOR SHACKLES

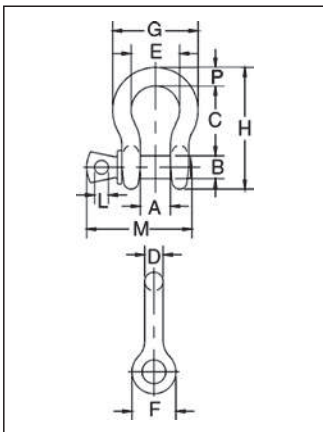

Nominal Size (inch)	Working Load Limit (ton)	Weight Each (lbs)	Dimensions (inch)											Tolerance + / -	
			A	B	C	D	E	F	G	H	L	M	P	C	A
3/16	1/3	.06	.38	.25	.88	.19	.60	.56	.98	1.47	.16	1.14	.19	.06	.06
1/4	1/2	.10	.47	.31	1.13	.25	.78	.61	1.28	1.84	.19	1.43	.25	.06	.06
5/16	3/4	.18	.53	.38	1.22	.31	.84	.75	1.47	2.09	.22	1.71	.31	.06	.06
3/8	1	.31	.66	.44	1.44	.38	1.03	.91	1.78	2.49	.25	2.02	.38	.13	.06
7/16	1-1/2	.38	.75	.50	1.69	.44	1.16	1.06	2.03	2.91	.31	2.37	.44	.13	.06
1/2	2	.72	.81	.63	1.88	.50	1.31	1.19	2.31	3.28	.38	2.69	.50	.13	.06
5/8	3-1/4	1.37	1.06	.75	2.38	.63	1.69	1.50	2.94	4.19	.44	3.34	.69	.13	.06
3/4	4-3/4	2.35	1.25	.88	2.81	.75	2.00	1.81	3.50	4.97	.50	3.97	.81	.25	.06
7/8	6-1/2	3.62	1.44	1.00	3.31	.88	2.28	2.09	4.03	5.83	.50	4.50	.97	.25	.06
1	8-1/2	5.03	1.69	1.13	3.75	1.00	2.69	2.38	4.69	6.56	.56	5.13	1.06	.25	.06
1-1/8	9-1/2	7.41	1.81	1.25	4.25	1.16	2.91	2.69	5.16	7.47	.63	5.71	1.25	.25	.06
1-1/4	12	9.50	2.03	1.38	4.69	1.29	3.25	3.00	5.75	8.25	.69	6.25	1.38	.25	.06
1-3/8	13-1/2	13.53	2.25	1.50	5.25	1.42	3.63	3.31	6.38	9.16	.75	6.83	1.50	.25	.13
1-1/2	17	17.20	2.38	1.63	5.75	1.54	3.88	3.63	6.88	10.00	.81	7.33	1.62	.25	.13
1-3/4	25	27.78	2.88	2.00	7.00	1.84	5.00	4.19	8.86	12.34	1.00	9.06	2.25	.25	.13
2	35	45.00	3.25	2.25	7.75	2.08	5.75	4.81	9.97	13.68	1.22	10.35	2.40	.25	.13
2-1/2	55	85.75	4.13	2.75	10.50	2.71	7.25	5.69	12.87	17.84	1.38	13.00	3.13	.25	.25

US Specifications

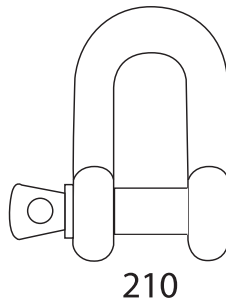

SCREW PIN CHAIN SHACKLES

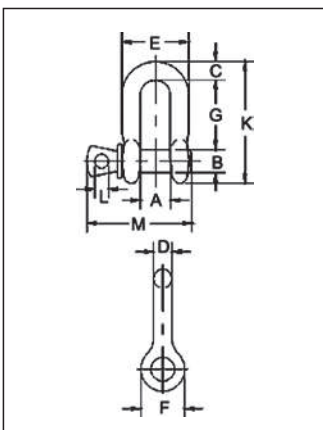

Nominal Size (inch)	Working Load Limit (ton)	Weight Each (lbs)	Dimensions (inch)											Tolerance + / -	
			A	B	C	D	E	F	G	K	L	M	G	A	
1/4	1/2	.11	.47	.31	.25	.25	.97	.62	.97	1.59	.19	1.43	.06	.06	
5/16	3/4	.17	.53	.38	.31	.31	1.15	.75	1.07	1.91	.22	1.71	.06	.06	
3/8	1	.28	.66	.44	.38	.38	1.42	.92	1.28	2.31	.25	2.02	.13	.06	
7/16	1-1/2	.43	.75	.50	.44	.44	1.63	1.06	1.48	2.67	.31	2.37	.13	.06	
1/2	2	.59	.81	.63	.50	.50	1.81	1.18	1.66	3.03	.38	2.69	.13	.06	
5/8	3-1/4	1.25	1.06	.75	.63	.63	2.32	1.50	2.04	3.76	.44	3.34	.13	.06	
3/4	4-3/4	2.63	1.25	.88	.81	.75	2.75	1.81	2.40	4.53	.50	3.97	.25	.06	
7/8	6-1/2	3.16	1.44	1.00	.97	.88	3.20	2.10	2.86	5.33	.50	4.50	.25	.06	
1	8-1/2	4.75	1.69	1.13	1.00	1.00	3.69	2.38	3.24	5.94	.56	5.13	.25	.06	
1-1/8	9-1/2	6.75	1.81	1.25	1.25	1.13	4.07	2.69	3.61	6.78	.63	5.71	.25	.06	
1-1/4	12	9.06	2.03	1.38	1.38	1.25	4.53	3.00	3.97	7.50	.69	6.25	.25	.13	
1-3/8	13-1/2	11.63	2.25	1.50	1.50	1.38	5.01	3.31	4.43	8.28	.75	6.53	.25	.13	
1-1/2	17	15.95	2.38	1.63	1.62	1.50	5.38	3.62	4.87	9.05	.81	7.33	.25	.13	
1-3/4	25	26.75	2.88	2.00	2.12	1.75	6.38	4.19	5.78	10.97	1.00	9.06	.25	.13	
2	35	42.31	3.25	2.25	2.36	2.10	7.25	5.00	6.77	12.74	1.13	10.35	.25	.13	
2-1/2	55	71.75	4.12	2.75	2.63	2.63	9.38	5.68	8.07	14.85	1.38	13.00	.25	.25	

US Specifications

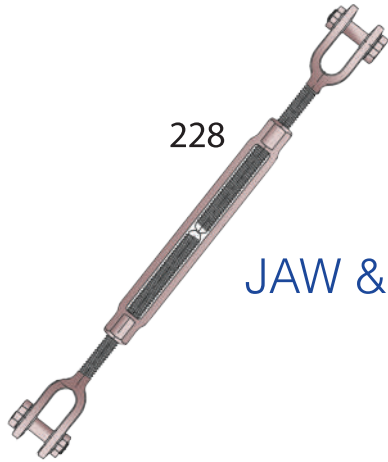

228

JAW & JAW TURNBUCKLES

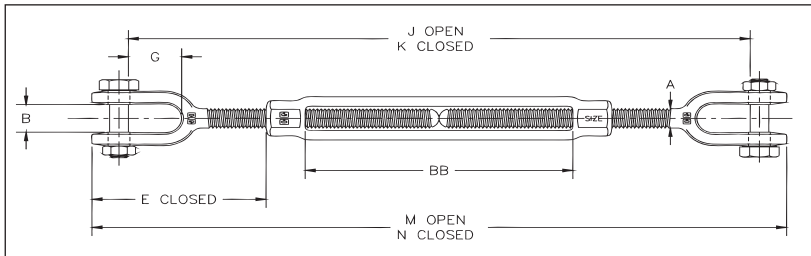

Working Load Limit (lbs)	Weight Each (lbs)	Dimensions (inch)								
		A	B	E Closed	G	J Open	K Closed	M Open	N Closed	BB
500	.37	.25	.45	1.66	.64	11.19	7.19	12.18	8.18	4.07
800	.56	.31	.50	2.02	.87	13.07	8.57	14.12	9.62	4.58
1200	.85	.38	.53	2.11	.85	16.25	10.25	17.50	11.50	6.10
2200	1.82	.50	.64	3.22	1.07	18.65	12.65	20.14	14.14	6.03
2200	2.29	.50	.64	3.20	1.07	24.94	15.94	26.43	17.43	9.36
2200	2.71	.50	.64	3.20	1.07	30.94	18.94	32.43	20.43	12.36
3500	3.21	.63	.79	3.90	1.32	19.74	13.74	21.82	15.82	6.03
3500	3.95	.63	.79	3.89	1.32	26.08	17.08	28.16	19.16	9.39
3500	4.58	.63	.79	3.89	1.32	32.08	20.08	34.16	22.16	12.39
5200	4.80	.75	.97	4.71	1.52	21.09	15.09	23.68	17.68	6.13
5200	5.85	.75	.97	4.68	1.52	27.49	18.49	30.08	21.08	9.59
5200	6.72	.75	.97	4.68	1.52	33.49	21.49	36.08	24.08	12.59
5200	8.45	.75	.97	4.71	1.52	45.49	27.49	48.08	30.08	18.53
7200	9.37	.88	1.16	5.50	1.77	34.65	22.65	37.62	25.62	12.16
7200	11.8	.88	1.16	5.50	1.77	47.12	29.12	50.09	32.09	18.63
10000	10.4	1.00	1.34	6.09	2.05	23.82	17.82	27.18	21.18	6.18
10000	13.8	1.00	1.34	6.09	2.05	35.82	23.82	39.18	27.18	12.18
10000	17.1	1.00	1.34	6.09	2.05	47.82	29.82	51.18	33.18	18.18
10000	21.0	1.00	1.34	6.06	2.05	60.42	36.42	63.78	39.78	24.84
15200	21.9	1.25	1.84	8.09	2.82	39.37	27.37	43.58	31.58	12.06
15200	25.9	1.25	1.84	8.09	2.82	51.37	33.37	55.58	37.58	18.06
15200	29.8	1.25	1.84	8.09	2.82	63.93	39.93	68.14	44.14	24.62
21400	32.6	1.50	2.06	8.93	2.81	40.76	28.76	45.68	33.68	12.32
21400	38.0	1.50	2.06	8.93	2.81	52.76	34.76	57.68	39.68	18.32
21400	43.5	1.50	2.06	8.93	2.81	65.38	41.38	70.30	46.30	24.94
28000	53.5	1.75	2.60	9.36	3.35	53.35	35.35	59.16	41.16	18.37
28000	61.1	1.75	2.60	9.36	3.35	65.35	41.35	71.16	47.16	24.37
37000	96.3	2.00	2.62	11.80	3.74	69.64	45.64	76.72	52.72	24.48
60000	167	2.50	3.06	13.26	4.44	72.97	48.97	82.18	58.18	24.60
75000	199	2.75	3.69	14.92	4.19	74.75	50.75	85.50	61.50	24.65

US Specifications

Turnbuckles



225

HOOK & EYE TURNBUCKLES

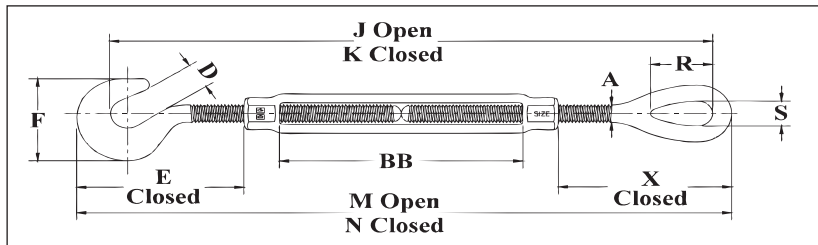

Working Load Limit (lbs)	Weight Each (lbs)	Dimensions (inch)											
		A	D	E Closed	F	J Open	K Closed	M Open	N Closed	R	S	X Closed	BB
400	.31	.25	.44	.167	.127	11.66	.766	12.29	8.29	.81	.34	1.76	4.07
700	.50	.31	.50	2.00	1.50	13.50	9.00	14.28	9.78	.95	.44	2.20	4.58
1000	.79	.38	.56	2.28	1.76	17.09	11.09	18.04	12.04	1.13	.53	2.48	6.10
1500	1.80	.50	.65	3.53	2.28	19.57	13.57	20.79	14.79	1.41	.71	3.56	6.03
1500	2.70	.50	.65	3.51	2.28	31.86	19.86	33.08	21.08	1.41	.71	3.54	12.36
2250	2.98	.63	.90	4.24	2.81	21.11	15.11	22.61	16.61	1.80	.88	4.35	6.03
2250	4.35	.63	.90	4.23	2.81	33.45	21.45	34.95	22.95	1.80	.88	4.34	12.39
3000	4.21	.75	.98	5.07	3.33	22.61	16.61	24.45	18.45	2.09	1.00	5.12	6.13
3000	6.52	.75	.98	5.04	3.33	35.01	23.01	36.85	24.85	2.09	1.00	5.09	12.59
3000	8.24	.75	.98	5.07	3.33	47.01	29.01	48.85	30.85	2.09	1.00	5.12	18.53
4000	9.34	.88	1.13	5.82	3.78	36.11	24.11	38.23	26.23	2.38	1.25	5.79	12.16
5000	13.9	1.00	1.25	6.56	4.25	37.65	25.65	40.06	28.06	3.00	1.43	6.50	12.18

US Specifications

JIS-Type Galvd Shackle

BOW SCREWPIN SHACKLE



Size (mm)	W.L.L (kg)	I.L. (mm)	N.W. (kg)
5	90	19	0.026
6	150	25	0.028
8	250	32	0.065
10	400	38	0.080
12	600	51	0.200
16	800	64	0.495
20	1000	76	0.800
22	1500	89	1.260
25	2000	100	1.900
28	2500	115	2.650

DEE SCREWPIN SHACKLE



Size (mm)	W.L.L (kg)	I.L. (mm)	N.W. (kg)
5	90	16	0.014
6	150	22	0.028
8	250	27	0.049
10	400	31	0.073
12	600	40	0.180
16	800	51	0.420
20	1000	64	0.720
22	1500	75	1.180
25	2000	183	1.800
28	2500	96	2.500

Stainless Steel Products





100% NYLON 3-Strand Rope

- High tensile strength and good elasticity
- Double construction
- Elongation: 35% at break
- Good abrasion resistance
- Good resistance to chemical & decay
- Excellent shock absorption
- Melting point: 220°C
- Specific gravity: 1.14

SIZE		WEIGHT		BS	
Dia (mm)	Cir (inch)	220m (kg)	600ft (lbs)	(ton)	(kN)
6	3/4	5.00	9.20	1.20	11.80
7	7/8	6.70	12.30	1.40	13.70
8	1	8.80	16.20	1.70	16.70
9	1-1/8	11.20	20.50	1.90	18.60
10	1-1/4	13.60	24.90	2.40	23.50
12	1-1/2	19.60	35.90	3.40	33.30
14	1-3/4	27.00	49.50	4.50	44.10
16	2	35.00	64.10	5.80	56.90
18	2-1/4	44.00	80.60	7.20	70.60
20	2-1/2	54.00	99.00	9.50	93.20
22	2-3/4	66.00	121.00	12.20	119.60
24	3	78.00	143.00	14.30	140.20
26	3-1/4	92.00	169.00	15.80	154.90
28	3-1/2	107.00	196.00	17.80	174.60
30	3-3/4	122.00	224.00	20.00	196.10
32	4	139.00	255.00	22.00	215.70
34	4-1/4	156.00	286.00	24.50	240.30
36	4-1/2	176.00	323.00	28.00	274.60



100% NYLON 8-Strand Rope

SIZE		WEIGHT		BS	
Dia (mm)	Cir (inch)	220m (kg)	600ft (lbs)	(ton)	(kN)
40	5	218.00	400.00	35.00	343.20
48	6	312.00	572.00	48.50	475.60
56	7	425.00	779.00	64.00	627.60
64	8	554.00	1,015.00	82.50	809.10
72	9	702.00	1,286.00	102.00	1,000.30
80	10	867.00	1,589.00	125.00	1,225.80
88	11	1,049.00	1,922.00	148.00	1,451.40
96	12	1,250.00	2,291.00	173.00	1,696.50
112	14	1,698.00	3,112.00	225.00	2,206.50
120	15	1,950.00	3,574.00	256.00	2,510.50

- APPLICATIONS**
- Mooring line
 - Offshore
 - Anchor line
 - Other industrial heavy-duty use
 - Towing line
 - Buoy line
 - Docking line

Fibre Ropes

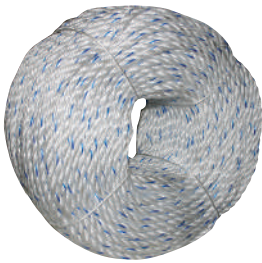

POLYPROPYLENE MONOFILAMENT 3-Strand Rope

WEIGHT & MINIMUM BREAKING LOAD (ISO & BS STANDARD)

* Available Sizes, 3-Strand Rope: 4mm up to 36mm Dia

* For Weight & MBL of Other Sizes & Lengths, Please Calculate Proportionally.

SIZE			POLYPROPYLENE (ISO 1346: 1990-E)		
Dia (mm)	Dia (inch)	Cir (inch)	Weight (kg/200m)	Weight (kg/220m)	Breaking Load (ton)
4	5/32	1/2	1.5	1.32	0.28
6	7/32	3/4	3	2.45	0.4
8	5/16	1	6	3.74	1.06
9	11/32	1-1/8	8	5.10	1.19
10	3/8	1-1/4	9	6.60	1.5
12	1/2	1-1/2	12	8.10	2.2
14	9/16	1-3/4	18	9.90	3
16	5/8	2	22	14.30	3.7
18	3/4	2-1/4	29	20.00	4.8
20	13/16	2-1/2	36	25.30	5.8
22	7/8	2-3/4	43	32.50	6.9
24	1	3	50	40.00	8
26	1-1/16	3-1/4	60	48.40	9.4
28	1-1/8	3-1/2	67	57.00	10.7
30	1-1/4	3-3/4	80	67.00	12.2
32	1-5/16	4	90	78.00	13.5
36	1-7/16	4-1/2	117	89.00	16.9



POLYPROPYLENE MONOFILAMENT 8-Strand Rope

(Standard for mooring)

* Available Canvas covered eye-splice(s) • Mill's or Lloyd's certs. • UV, Stabilization • Any colours

* Max. W.L.L. - about 20% of MBL Elongation at S.W.L. 16% below * Tested on BS.5053 & 4928 ISO - 2307

SIZE		WEIGHT & MBL		
Dia (mm)	Cir (inch)	Weight (kg/200m)	Weight (kg/220m)	MBL (ton)
40	5	143	158	26
44	5-1/2	176	194	30
48	6	205	225	36
52	6-1/2	244	268	42
56	7	277	305	48
60	7-1/2	326	359	55
64	8	370	407	62
68	8-1/2	419	461	70
72	9	462	508	77.5
80	10	560	616	95.5
84	10-1/2	655	720	107
88	11	696	766	116
96	12	818	909	136
104	13	978	1,076	158
112	14	1,140	1,254	183
120	15		1,300kgs / 200m	208
128	16		1,300kgs / 175m	235



POLYPROPYLENE MULTIFILAMENT 3 Strand Rope

** For Weight & MBL of Other Sizes & Lengths, Please Calculate Proportionally*

SIZE			WEIGHT & MBL		
Dia (mm)	Dia (inch)	Cir (inch)	kg/100m	kg/220m	MBL (ton)
4	5/32	1/2	0.63	1.39	0.21
5	3/16	5/8	1.17	2.57	0.32
6	7/32	3/4	1.79	3.93	0.44
8	5/16	1	3.14	6.90	0.75
9	11/32	1-1/8	3.86	8.5	0.93
10	3/8	1-1/4	4.73	10.4	1.13
12	1/2	1-1/2	6.82	15.0	1.66
14	9/16	1-3/4	9.55	21.0	2.21
16	5/8	2	12.1	26.6	2.83
18	3/4	2-1/4	15.5	34.1	3.52
20	13/16	2-1/2	19.1	42.0	4.29
22	7/8	2-3/4	23.1	50.8	5.12
24	1	3	27.2	59.9	6.02
26	1-1/16	3-1/4	32	70.40	6.98
28	1-1/8	3-1/2	37.2	81.9	8.02
30	1-1/4	3-3/4	42.5	93.5	9.11
32	1-5/16	4	48.2	106.1	10.3
36	1-7/16	4-1/2	61.6	135.5	13.7



POLYPROPYLENE MULTIFILAMENT 8 Strand Rope

** For Weight & MBL of Other Sizes & Lengths, Please Calculate Proportionally*

SIZE			WEIGHT & MBL		
Dia (mm)	Dia (inch)	Cir (inch)	kg/100m	kg/220m	MBL (ton)
40	1-5/8	5	75.4	165.9	20.50
44	1-3/4	5-1/2	92.6	203.7	24.60
48	1-15/16	6	109.3	240.5	28.60
52	2-1/8	6-1/2	127.9	281.4	33.10
56	2-1/4	7	148.9	327.6	37.90
60	2-3/8	7-1/2	171.4	377.0	43.30
64	2-1/2	8	194.3	427.4	49.00
72	2-7/8	9	245.8	540.8	61.50
80	3-1/4	10	304.5	669.9	75.60
88	3-1/2	11	368.5	810.6	90.80
96	3-3/4	12	437.2	961.8	107.0
104	4-1/8	13	514.5	1,131.9	122.9
112	4-1/2	14	598.5	1,316.7	141.80
120	4-3/4	15	682.5	1,501.5	162.90

Fibre Ropes

PAWA™ MIXED ROPE



APPLICATIONS

- Mooring line
- Towing line
- Offshore / Tankers
- Specialized Operations

Korea Mixed Ropes

- Double Construction
- Elongation: 18% at break
- Excellent abrasion resistance
- Long durability
- Good resistance to UV, Chemical
- Melting point: 265°C / 165°C
- Mixture of high performance polyester and polyolefin
- Specific gravity: 1.00 ~ 1.05
- Floating type available
- According to O.C.I.M.F. Guidelines

SIZE		WEIGHT		BS	
Dia (inch)	Cir (Inch)	220m (kg)	(ton)	(kN)	
40	5	201.00	32.00	313.80	
44	5 - 1/2	240.00	38.00	327.70	
48	6	291.00	44.00	431.50	
52	6 - 1/2	328.00	52.00	509.90	
56	7	396.00	59.00	578.60	
60	7 - 1/2	440.00	67.00	657.00	
64	8	490.00	76.00	745.30	
72	9	624.00	95.00	931.60	
80	10	766.00	115.00	1,127.80	
88	11	927.00	140.00	1,372.90	
96	12	1,102.00	166.00	1,627.90	

India Mixed Ropes

- Double Construction
- Elongation: 18% at break
- Excellent abrasion resistance
- Long durability
- Good resistance to UV, Chemical
- Melting point: 265°C / 165°C
- Mixture of high performance polyester and polyolefin
- Specific gravity: 1.00 ~ 1.05
- Floating type available
- According to O.C.I.M.F. Guidelines

SIZE		WEIGHT		BS	
Dia (inch)	Cir (Inch)	220m (kg)	(ton)	(kN)	
40	5	174	31.2	306.0	
44	5 - 1/2	213	38.0	327.7	
48	6	252	43.6	427.0	
52	6 - 1/2	295	52.0	509.9	
56	7	343	60.0	585.0	
60	7 - 1/2	395	67.0	657.0	
64	8	448	75.0	735.0	
72	9	566	90.0	880.0	
80	10	701	114.0	1117.9	
88	11	850	140.00	1,372.90	
96	12	1007	166.00	1,627.90	



POLYETHYLENE ROPE 4-Strand Coloured Rope

WEIGHT & MINIMUM BREAKING LOAD (ISO & BS STANDARD)

* Available Sizes, 4-Strand Rope: 4mm up to 30mm Dia

* For Weight & MBL of Other Sizes & Lengths, Please Calculate Proportionally.

SIZE			POLYETHYLENE (ISO 1969: 1990-E)	
Dia (mm)	Dia (inch)	Cir (inch)	Weight (kg/220m)	MBL (kgf or ton)
4	5/32	1/2	1.78	200 kgf
6	7/32	3/4	4.00	400
8	5/16	1	7.20	700
9	11/32	1-1/8	9.00	890
10	3/8	1-1/4	10.80	1,090
12	1/2	1-1/2	15.80	1,540
14	9/16	1-3/4	21.00	2,090
16	5/8	2	28.00	2,80 Ts
18	3/4	2-1/4	35.00	3.50
20	13/16	2-1/2	44.00	4.30
22	7/8	2-3/4	53.00	5.10
24	1	3	65.00	6.10
26	1-1/16	3-1/4	72.00	7.00
28	1-1/8	3-1/2	86.00	8.20
30	1-1/4	3-3/4	101.00	9.50



MANILA ROPE 3-Strand

FEATURES

- Vegetable fiber
- Stronger when wet

- Cordage oil retards water absorption
- Cordage oil reduces internal friction
- Susceptible to chemicals

NOMINAL SIZE			LINEAR DENSITY		NEW ROPE MIN. BREAKING FORCE		DESIGN FACTOR	WORKING LOAD LIMITS
Dia (inch)	Dia (mm)	Size No.	lbs/100	(ktex)	lbs	(daN)	Range	Range (lbs)
2/15	5	5/15	1.37	(20.3)	05	(180)	5-12	34 (15)-81 (36)
1/4	6	3/4	1.82	(27.1)	540	(240)	5-12	45 (20)-108 (48)
5/13	8	1	2.64	(39.2)	900	(400)	5-12	75 (33)-180 (80)
3/8	10	1 1/6	3.79	(56.5)	1,215	(540)	5-12	101 (45)-243 (108)
7/25	11	1 1/4	4.87	(72.5)	1,575	(701)	5-12	131 (58)-315 (140)
1/2	12	1 1/2	6.99	(104)	2,385	(1,061)	5-12	199 (88)-477 (212)
8/4	14	1 3/4	9.63	(143)	3,105	(1,381)	5-12	259 (115)-621 (276)
5/8	16	2	12.7	(189)	3,960	(1,761)	5-12	330 (147)-792 (352)
1/4	18	2 1/4	15.9	(236)	4,880	(2,162)	5-12	405 (180)-972 (432)
13/18	20	2 1/2	16.5	(276)	5,850	(2,602)	5-12	488 (217)-1,170 (520)
7/8	22	2 3/4	21.4	(318)	6,930	(3,082)	5-12	578 (267)-1,388 (616)
1	24	3	25.7	(382)	8,100	(3,603)	5-12	675 (300)-1,620 (721)
1 1/18	26	3 1/4	29.8	(443)	9,450	(4,203)	5-12	788 (350)-1,890 (841)
1 1/8	28	3 1/2	34.3	(510)	10,800	(4,804)	5-12	900 (400)-2,180 (961)
1 1/4	30	3 3/4	39.7	(591)	12,150	(4,404)	5-12	1,013 (450)-2,430 (1,081)
1 1/14	32	4	45.6	(678)	13,500	(6,005)	5-12	1,125 (500)-2,700 (1,201)
1 1/2	36	4 1/2	57.0	(849)	15,650	(7,400)	5-12	1,388 (617)-3,330 (1,481)
1 3/8	40	5	71.1	(1,058)	20,250	(9,007)	5-12	1,688 (751)-4,050 (1,801)
1 3/4	44	5 1/2	85.0	(1,265)	23,850	(10,608)	5-12	1,988 (884)-4,770 (2,122)
2	48	6	102	(1,524)	27,900	(12,410)	5-12	2,325 (1,034)-5,580 (2,482)

APPLICATIONS • Fisheries • Boat Rope • Etc.

Mooring Equipment

MOORING TAIL

11m finished length (from eye to eye), with 1.8m eye splice at both ends, eye splice with minimum 5 tucks and protected with canvas (or PVC)

O.C.I.M.F. Guidelines

- Nylon Tail > 137% MBL of Wire Rope
- Composite Tail > 125% MBL of Wire Rope



ITEM	SIZE		WEIGHT		BS	
	Dia (mm)	Cir (inch)	(kg)	(lbs)	(ton)	(kN)
NYLON 8 - STRAND	64	8	44.00	97.00	82.50	809.10
	72	9	57.00	125.70	102.00	1,000.30
	80	10	72.00	158.70	125.00	1,225.80
	88	11	87.00	191.80	148.00	1,451.40
	96	12	104.00	229.30	173.00	2,010.40
NYLON 12 - STRAND	64	8	44.00	97.00	90.00	882.60
	72	9	57.00	125.70	115.00	1,127.80
	80	10	72.00	158.70	138.00	1,353.30
	88	11	87.00	191.80	160.00	1,569.10
	96	12	104.00	229.30	191.00	1,873.10
PAWA™ KOREA	64	8	39.00	86.00	76.00	745.30
	72	9	50.50	111.30	95.00	931.60
	80	10	63.00	138.90	115.00	1,127.80
	88	11	76.00	167.60	140.00	1,372.90
	96	12	91.50	201.70	166.00	1,627.90
PAWA™ INDIA	64	8	45.00	99.21	92.00	902.00
	72	9	60.00	132.28	115.00	1,128.00
	80	10	74.00	163.14	156.00	1,530.00
	88	11	95.00	209.44	190.00	1,863.00
	96	12	101.00	222.67	201.00	1,971.00

TONSBERG TYPE MOORING LINK

Galvanized steel mooring link of compact design typically utilized as connection between wire rope and fiber forerunner.

Sizes: 90, 120, 180 & 300 M/ton

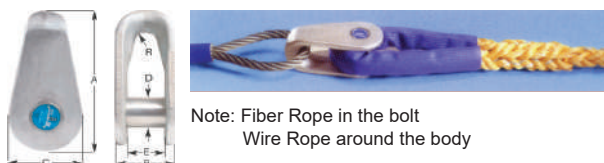

Note: Fiber Rope in the bolt
Wire Rope around the body

MODEL	90T	120T	180T
Forerunner Cir (inch)	7 - 9	9 - 11	11 - 15
A (mm)	285	324	350
B (mm)	115	142	184
C (mm)	136	150	160
D (mm)	65	75	85
E (mm)	75	90	120
R (mm)	22	28	30
Breaking Load M/ton	90	120	180
Proof Load M/ton	55	70	95
Safe Working Load M/ton	30	40	60
Weight	11,2 kg (25 lbs)	16,9 kg (37 lbs)	25 kg (55 lbs)

MANDAL TYPE FAIRLEAD SHACKLE

Stainless steel mooring shackle with sleek shape designed to pass through fairleads.

Sizes: 90, 120 & 300 M/ton



Note: Wire Rope in the sheave
Fiber Rope around the body

MODEL	90M	120M
Forerunner Cir (inch)	6 - 9	9 - 11
A (mm)	255	310
B (mm)	97	121
C (mm)	120	130
D (mm)	65	82
E (mm)	67	90
F (mm)	100	128
R (mm)	34	45
Breaking Load M/ton	90	120
Proof Load M/ton	55	70
Safe Working Load M/ton	30	40
Weight	7,8 kg (17.2 lbs)	13,3 kg (29 lbs)

Webbing Sling



Product Code	Color	WLL	Technical Data Mode Factors for limits in (kg)					'W' Width (mm)	'T' Standard Eye Length
			Straight Lift M (kg)	Choked Lift M = 0.8	'U' Lift M = 2.0	45 Deg Lift M = 1.4	60 Deg Lift M = 1.0		
010	Grey	WLL 1 ton	1000	800	2000	1400	1000	25	300
020	Green	WLL 2 ton	2000	1600	4000	2800	2000	50	300
030	Yellow	WLL 3 ton	3000	2400	6000	4200	3000	75	400
040	Grey	WLL 4 ton	4000	3200	8000	5600	4000	100	400
050	Red	WLL 5 ton	5000	4000	10000	7000	5000	125	450
060	Brown	WLL 6 ton	6000	4800	12000	8400	6000	150	600
080	Blue	WLL 8 ton	8000	6400	16000	11200	8000	200	600
100	Black	WLL 10 ton	10000	8000	20000	14000	10000	250	900
120	Orange	WLL 12 ton	12000	9600	24000	16800	12000	300	900

Round Sling



Product Code	Color	WLL	Technical Data Mode Factors for limits in (kg)					Approx. Sleeve width (mm)
			Straight Lift M (kg)	Choked Lift M = 0.8	'U' Lift M = 2	45 Deg Lift M = 1.4	SWL 60 Deg Lift M = 1.0	
010	Grey	WLL 1 ton	1000	800	2000	1400	1000	38
020	Green	WLL 2 ton	2000	1600	4000	2800	2000	50
030	Yellow	WLL 3 ton	3000	2400	6000	4200	3000	54
040	Grey	WLL 4 ton	4000	3200	8000	5600	4000	67
050	Red	WLL 5 ton	5000	4000	10000	7000	5000	72
060	Brown	WLL 6 ton	6000	4800	12000	8400	6000	75
080	Blue	WLL 8 ton	8000	6400	16000	11200	8000	90
100	Black	WLL 10 ton	10000	8000	20000	14000	10000	95
120	Orange	WLL 12 ton	12000	9600	24000	16800	12000	110
150	Black	WLL 15 ton	15000	12000	30000	21000	15000	110
200	Orange	WLL 20 ton	20000	16000	40000	28000	20000	132

Polyester Flat Woven Webbing Belt (Lashing) to EN12195-2



Specifications	SWL (kg)	MBL (kg)
1-1/2" X 1.4 m	800	1600
2" X 6m	2500	5000
2" X 9.6 m	2500	5000
2" X 12 m	2500	5000
3" X 10 m	5000	10000

Chain Block VL5 Series

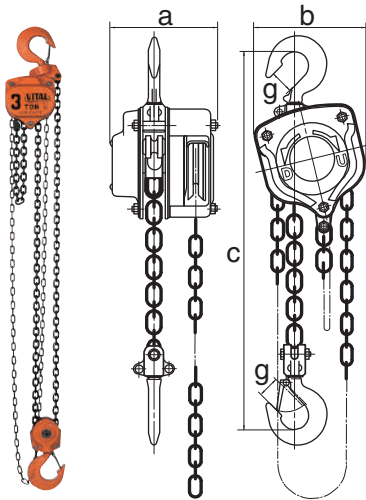

Capacity (ton)	Model Number	Standard Lift (m)	Net Weight (kg)	Gross Weight (kg)	Pull to Lift Load		Headroom c (mm)	a (mm)	b (mm)	g (mm)	Test Load (ton)
					(kgf)	(N)					
½	VL5-05	2.5	8.3	8.7	25	245	285	129	145	27	0.75
1	VL5-10	2.5	11.3	11.8	33	324	315	149	158	30	1.5
1½	VL5-15	2.5	13.5	14.0	34	333	340	149	177	34	2.25
2	VL5-20	3.0	21.0	22.2	34	333	380	181	204	37	3.0
3	VL5-30	3.0	22.0	22.7	35	343	475	149	208	43	4.5
5	VL5-50	3.0	40.0	41.5	39	382	600	181	263	47	7.5
7½	VL5-75	3.5	59.0	66.5	41	402	700	181	354	67	9.5
10	VL5-90	3.5	77.0	84.5	41	402	740	181	367	67	12.5

Chain Block VH5 Series 15T - 20T

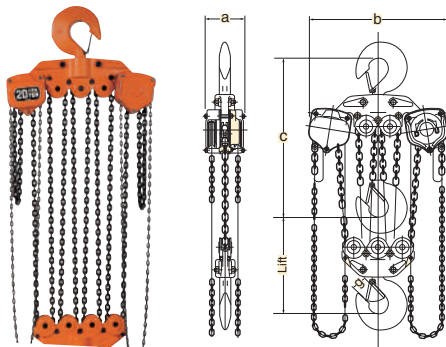

Capacity (ton)	Model Number	Standard Lift (m)	Net Weight (kg)	Gross Weight (kg)	Pull to Lift Load		Headroom c (mm)	a (mm)	b (mm)	g (mm)	Test Load (ton)
					(kgf)	(N)					
15	VH5-92	5	150.0	174.0	41x2	402x2	850	209	730	84	18.75
20	VH5-93	5	190.0	220.0	41x2	402x2	870	209	858	84	25.0

Lever Hoists VR2

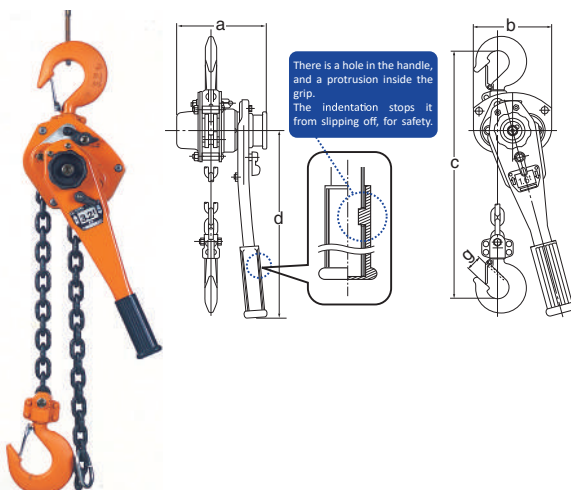

Model Number	VR2-08	VR2-10	VR2-15	VR2-30	VR2-60
Capacity (ton)	0.8	1	1.6	3.2	6.3
Standard Lift (m)	1.5	1.5	1.5	1.5	1.5
Net Weight (kg)	6.9	7.1	9.7	16.3	26.7
Min. Distance between Hooks (mm)	295	310	335	405	550
Pull Required to Lift Full Load	(kgf)	15	20	18	38
	(N)	147	196	177	373
Chain thickness (mm)	6.3	6.3	7.1	9.0	9.0
Dimension	a (mm)	148	148	163.5	191
	b (mm)	128	128	148	181
	c (mm)	295	310	325	395
	d (mm)	256	256	368	368
	g (mm)	27	30	34	43



CLOSED SPELTER SOCKET

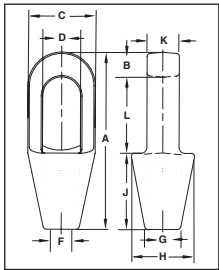

Rope Dia.		Ultimate Load (ton)	Weight (kg)	Dimensions (mm)									
(inch)	(mm)			A	B	C	D	F	G	H	J	K	L
1/4	6-7	4.5	0.23	116	12.7	39.6	22.4	9.65	17.5	39.6	57.2	12.7	46
5/16 - 3/8	8-10	12	0.34	125	15.8	42.9	24.6	12.7	20.6	42.9	57.2	17.5	52.3
7/16 - 1/2	11-13	20	0.68	140	17.5	51	29.5	14.2	23.9	51	63.5	22.4	58.7
9/16 - 5/8	14-16	30.8	1.13	162	20.6	67	35.8	17.5	30.2	67	76.2	25.4	65
3/4	18	43.5	1.92	194	26.9	76.2	42.2	22.4	33.3	70	89	31.8	77.7
7/8	20-22	65.3	3.28	226	33.3	92	49.3	25.4	38.1	82.5	102	38.1	90.5
1	24-26	81.6	4.76	254	36.6	105	58.5	28.7	44.5	95.5	114	44.5	103
1-1/8	28-30	100	6.46	283	39.6	114	65	31.8	51	105	127	51	116
1-1/4 - 1-3/8	32-35	136	8.95	309	41.4	127	71	38.1	58.5	119	138	56.5	129
1-1/2	38	170	13.24	355	49.3	137	81	41.4	70.5	132	151	62.5	155
1-5/8	40-42	188	16.32	390	54	146	82.5	44.5	76.2	140	165	70	171
1-3/4 - 1-7/8	44-48	268	25.96	445	55.5	171	95.5	51	79.5	162	191	76.2	198
2 - 2-1/8	50-54	309	35.83	505	62	194	111	57.2	95.5	187	216	82.5	224
2-1/4 - 2-3/8	56-60	360	47.62	546	70	216	127	66.8	105	210	229	92	248
2-1/2 - 2-5/8	64-67	424	63.5	597	79.5	241	140	74.5	114	235	248	102	270
2-3/4 - 2-7/8	70-73	549	99.79	645	79.5	273	159	79.5	124	259	279	124	286
3 - 3-1/8	75-58	656	125	689	85.6	292	171	86	133	292	305	133	298
3-1/4 - 3-3/8	82-86	750	142	743	102	311	184	92	146	311	330	146	311
3-1/2 - 3-5/8	88-92	820	181	787	102	330	197	98.5	160	330	356	159	330
3-3/4 - 4	94-102	1005	246	845	108	362	216	108	184	362	381	178	356

US Specifications



MOORING SOCKET

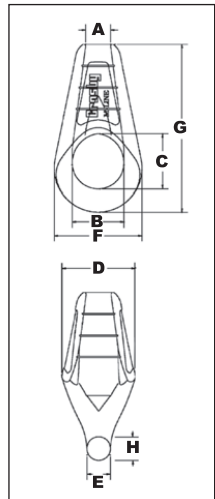

Wire Rope Size		Ultimate Load (ton)	Weight Each (kg)	Dimensions (mm)							
(inch)	(mm)			A	B	C	D	E	F	G	H
1-1/4 - 1-3/8	32-35	113	7.7	41.4	78.5	92.2	113	36.6	130	277	38.9
1-1/2 - 1-5/8	38-41	136	13.6	49.5	93.7	110	138	40.6	160	330	46
1-3/4 - 1-7/8	44-48	181	19.5	56.6	106	115	160	46.7	183	358	53.1
2 - 2-1/8	50-54	227	25.9	63.5	121	134	178	53.1	210	407	56.9
2-1/4 - 2-3/8	57-60	277	34.5	70.6	133	146	196	58.7	233	455	66.6
2-1/2 - 2-5/8	64-67	363	48.1	77.5	149	170	217	68.3	257	505	67.6
2-3/4 - 2-7/8	70-73	454	62.6	84.6	165	181	237	76.2	282	549	64
3 - 3-1/8	76-79	544	87.5	89.9	184	197	262	82.6	313	597	82.3
3-1/4 - 3-3/8	82-86	635	104	96.8	194	224	278	88.9	334	654	87.1
3-1/2 - 3-5/8	88-92	735	127	105	203	230	298	93.7	355	703	105
3 - 3/4 - 4	95-102	907	174	112	222	267	328	93.7	403	765	113

US Specifications

OPEN SPELTER SOCKET



Rope Dia		Ultimate Load (ton)	Weight (kg)	Dimensions (mm)										
(mm)	(inch)			A	C	D	F	G	H	J	L	M	N	
6-7	1/4	4.5	0.5	116	19.1	17.5	9.7	17.5	39.6	57.0	39.6	33.3	9.1	
8-10	5/16 - 3/8	12	0.59	123	20.6	20.6	12.7	20.6	42.9	57.0	44.5	38.1	11.2	
11-13	7/16 - 1/2	20	1.02	141	25.4	25.4	14.2	23.9	47.8	63.5	51.0	47.8	12.7	
14-16	9/16 - 5/8	27	1.63	171	31.8	30.2	17.5	28.7	57.0	76.0	63.5	57.0	14.2	
18	3/4	43	2.64	202	38.1	35.1	20.6	31.8	66.5	89.0	76.0	66.5	15.7	
20-22	7/8	55	4.38	235	44.5	41.4	23.9	38.1	82.5	102	89.0	79.5	20.3	
24-26	1	78	7.03	268	51.0	51.0	28.7	44.5	95.5	114	102	95.5	22.4	
28-30	1-1/8	92	9.75	300	57.0	57.0	31.8	51.0	105	127	117	105	25.4	
32-35	1-1/4 - 1-3/8	136	14.1	335	63.5	63.5	38.1	57.0	121	140	127	121	28.7	
38	1-1/2	170	21.4	384	76.0	70.0	41.4	70.0	133	152	152	137	30.2	
40-42	1-5/8	188	24.9	413	76.0	76.0	44.5	76.0	140	165	165	146	33.3	
44-48	1-3/4 - 1-7/8	268	37.2	464	89.0	89.0	51.0	79.5	162	191	178	165	39.6	
50-54	2 - 2-1/8	291	59	546	102	96	57	96	187	216	229	178	46.0	
56-60	2-1/4 - 2-3/8	360	76	597	114	108	64	102	210	229	254	197	54.0	
64-67	2-1/2 - 2-5/8	424	114	648	127	121	73	114	235	248	274	216	60.5	
70-73	2-3/4 - 2-7/8	511	143	692	133	127	79	124	267	279	279	229	73.0	
75-80	3 - 3-1/8	563	172	737	146	133	86	133	282	305	287	241	76.0	
82-86	3-1/4 - 3-3/8	722	197	784	159	140	92	146	302	330	300	254	79.0	
88-92	3-1/2 - 3-5/8	779	255	845	171	152	99	165	314	356	318	274	82.5	
94-102	3-3/4 - 4	875	355	921	191	178	108	184	346	381	343	318	89.0	

US Specifications

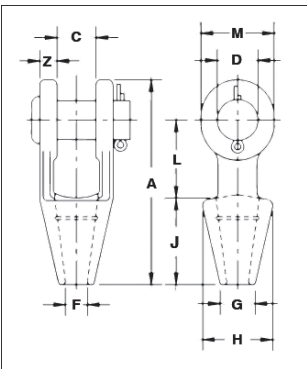

- 100% termination efficiency
- Temperature operating range is -65° F to +240° F (-54°C to +116°C)
- Ideal for on-site applications
- No hazardous molten metal
- Improved fatigue life
- Pouring temperature without booster pack is 48° F to 110° F (6.67°C to 43.3°C)
- One booster pack if pouring temperature is 35° F to 48° F (1.67°C to 8.89°C)
- Two booster packs if pouring temperature is 27° F to 35° F (-2.78°C to +1.67°C)
- Refer to Wire Rope End Terminations Manual for more information



Anchors

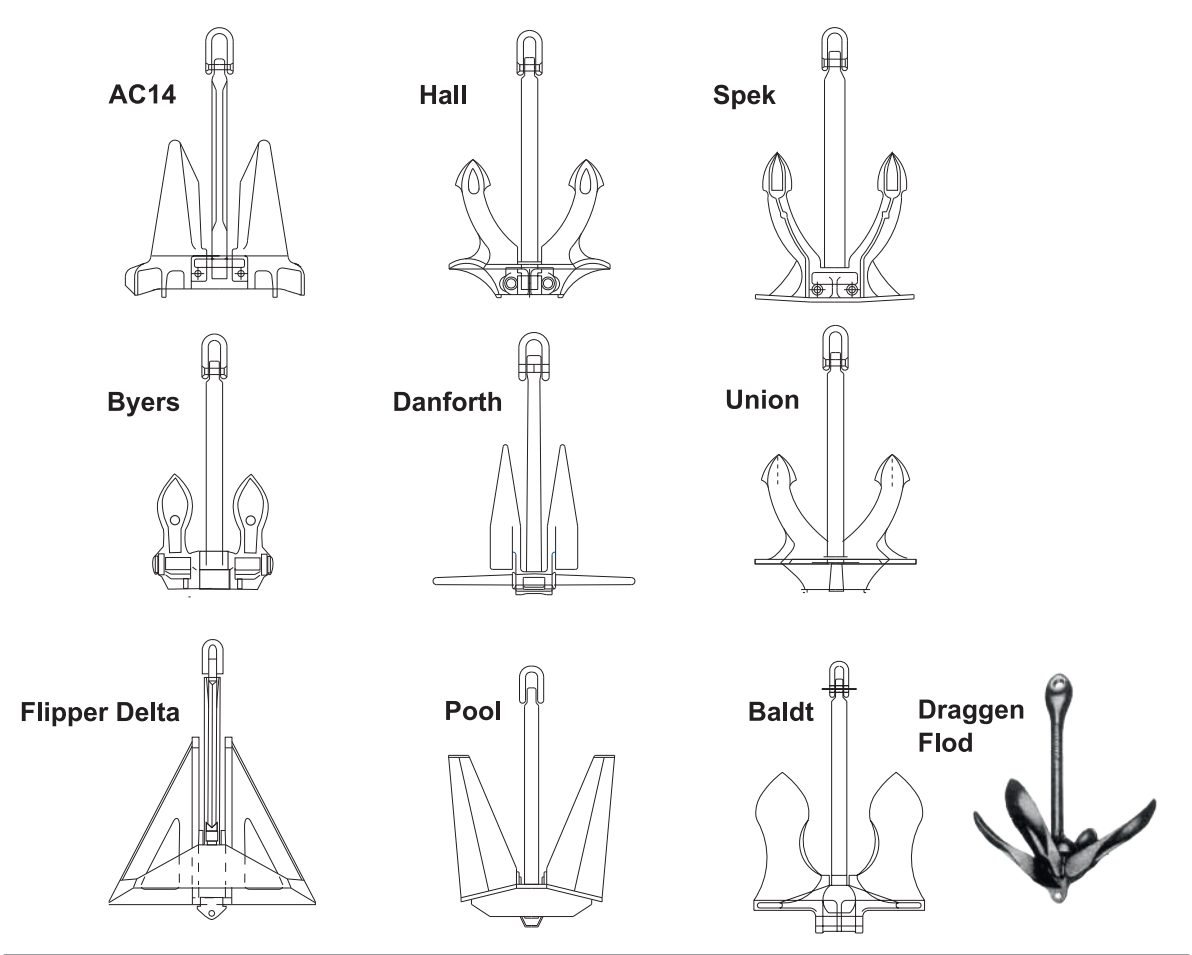

Anchors Chain & Swivel Set

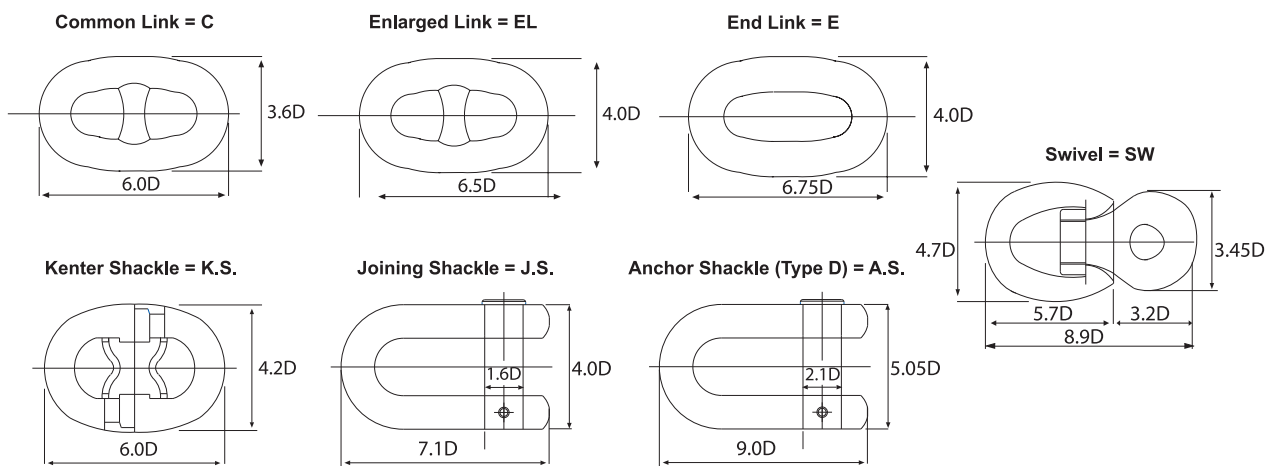

Anchors Chain & Swivel Set

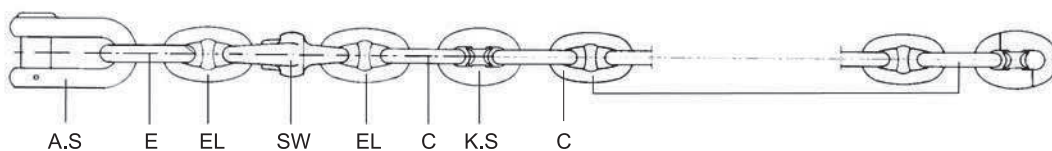

Chain Equipment Table

Stud Link Chain Cables			Anchors for ship			Towing Lines		Mooring Lines		
Diameter (mm)			Number	Anchor	H.P.P. Anchor	Length (m)	MBL (KN)	Quantity	Length (m)	MBL (KN)
Grade2	Grade3	Total length (m)		Weight (kg)						
12.5	-	220	2	180	135	180	100	3	80	35
14	-	220	2	240	180	180	100	3	100	40
16	-	247.5	2	300	225	180	100	3	110	40
17.5	-	247.5	2	360	270	180	100	3	110	45
17.5	-	275	2	420	315	180	100	3	120	50
19	-	275	2	480	360	180	100	3	120	55
20.5	-	302.5	2	570	430	180	110	3	120	60
22	20.5	302.5	2	660	495	180	130	4	120	65
24	22	330	3	780	585	180	150	4	120	70
26	24	357.5	3	900	675	180	175	4	140	80
28	24	357.5	3	1020	765	180	200	4	140	85
30	26	385	3	1140	855	180	225	4	140	95
32	28	385	3	1290	970	180	250	4	140	100
34	30	412.5	3	1440	1080	180	275	4	140	110
34	30	412.5	3	1590	1195	190	305	4	160	120
36	32	440	3	1740	1305	190	340	4	160	130
38	34	440	3	1920	1440	190	370	4	160	145
40	36	440	3	2100	1575	190	405	4	160	160
42	36	467.5	3	2280	1710	190	440	4	170	170
44	38	467.5	3	2460	1845	190	480	4	170	185
46	40	467.5	3	2640	1980	190	520	4	170	200
48	42	495	3	2850	2140	190	560	4	170	215
50	44	495	3	3060	2295	200	600	4	180	230
50	46	495	3	3300	2475	200	645	4	180	250
52	46	522.5	3	3540	2655	200	690	4	180	270
54	48	522.5	3	3780	2835	200	740	4	180	285
56	50	522.5	3	4050	3040	200	785	4	180	305
58	50	550	3	4320	3240	200	835	4	180	325
60	52	550	3	4590	3450	220	890	5	190	325
62	54	550	3	4890	3670	220	940	5	190	335
64	56	577.5	3	5250	3940	220	1025	5	190	350
66	58	577.5	3	5610	4210	220	1110	5	190	375
68	60	577.5	3	6000	4500	220	1170	5	190	400
70	62	605	3	6450	4840	240	1260	5	200	425
73	64	605	3	6900	5175	240	1355	5	200	450
76	66	605	3	7350	5515	240	1455	5	200	480
78	68	632.5	3	7800	5850	260	1470	6	200	480
81	70	632.5	3	8300	6225	260	1470	6	200	490
84	73	632.5	3	8700	6525	260	1470	6	200	500
84	76	660	3	9300	6975	280	1470	6	200	520
87	78	660	3	9900	7425	280	1470	6	200	555
90	78	660	3	10500	7875	280	1470	6	200	590
92	81	687.5	3	11100	8325	300	1470	6	200	620
95	84	687.5	3	11700	8775	300	1470	6	200	650
97	87	687.5	3	12300	9225	300	1470	7	200	650
100	87	715	3	12900	9675	300	1470	7	200	660
102	90	715	3	13500	10125	300	1470	7	200	670
105	92	715	3	14100	10575	300	1470	7	200	680
107	95	742.5	3	14700	11025	300	1470	7	200	685
111	97	742.5	3	15400	11550	300	1470	8	200	685
111	97	742.5	3	16100	12075	300	1470	8	200	685
114	100	742.5	3	16900	12675	300	1470	8	200	705
117	102	742.5	3	17800	13350	300	1470	9	200	705
120	107	742.5	3	18800	14100	300	1470	9	200	715
124	111	770	3	20000	15000	300	1470	9	200	725
127	114	770	3	21500	16125	300	1470	10	200	725
132	117	770	3	23000	17250	-	-	-	-	-

MOORING PIPE (JIS F-2007) TYPE A

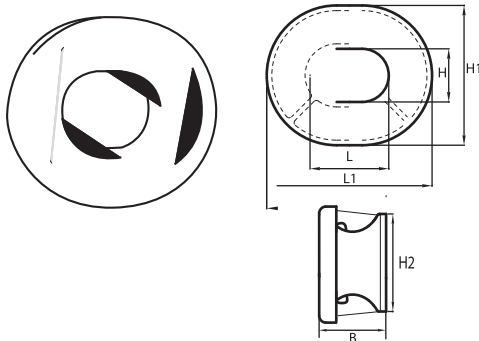

NOMINAL SIZE (mm)	L	L1	H	H1	H2	B	MASS (kg)
150	150	300	110	260	120	129	15
200	200	368	150	318	250	143	21
250	250	430	200	380	308	155	27
300	300	500	250	450	372	169	43
350	350	560	250	460	378	179	51
400	400	632	250	482	394	195	77
450	450	700	250	500	406	209	102
500	500	760	250	510	412	219	115

FAIRLEAD CHOKE (JIS F-2017) TYPE AC

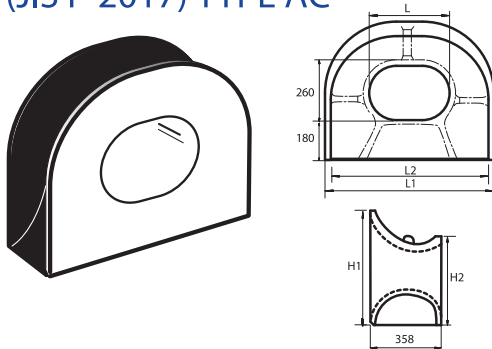

NOMINAL SIZE (mm)	L	L1	B	H1	H2	MASS (kg)
310	310	708	652	639	541	253
360	360	760	704	640	542	289
400	400	804	750	642	545	323
450	450	856	802	643	547	351
500	500	908	854	644	549	395

CHAIN STOPPER (JIS F-2002)

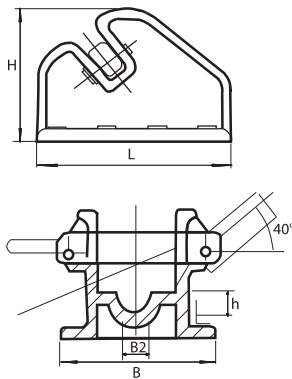

NOMINAL SIZE (mm)	CABLE DIA. (mm)	B	H	L	h	B2	MASS (kg)
19	17-19	195	190	270	32	32	22
22	20-22	215	216	310	37	38	31
25	23-25	240	241	345	43	43	44
28	26-28	265	270	385	48	49	58
32	30-32	305	305	435	54	55	89
36	34-36	340	342	490	61	61	122
40	38-40	370	378	540	68	65	160
44	42-44	405	412	590	75	72	208
48	46-48	440	450	640	82	78	272
52	50-52	470	491	695	88	85	338
56	54-56	495	522	745	95	92	414
60	58-60	530	564	795	102	98	505
64	62-64	565	600	850	109	104	618
68	66-68	590	635	900	116	110	737

Marine Blocks

BLOCK CARGO, STEEL, SINGLE - sheave without becket JIS F 3421 - 1989

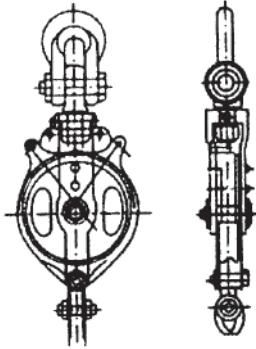

Code NO.	Type	Bracket	Sheave		Dia. W.R. (mm)	Shackle SB or BB	SWL (ton)	Weight (kg)
			Nos	Dia. (mm)				
23 15 01	1A	W/out	Single	220	12.5	22	1.4	16
02				240	14	28	1.75	21
03				280	16	30	2.25	33
04				340	20	34	3.5	52
05				430	25	42	5.5	84
06				480	28	48	7.0	123
23 15 07	2A	W/out	Double	240	14	34	6.5	47
08				280	16	38	8.5	67.5
09				340	20	46	13.0	114
10				430	25	60	21.0	205
11				480	28	70	28.0	314

Denotes, 1- Single Block, 2 - Double Block
A - Without Bracket

BLOCK CARGO, STEEL, SINGLE - sheave without becket JIS F 3428 - 1995

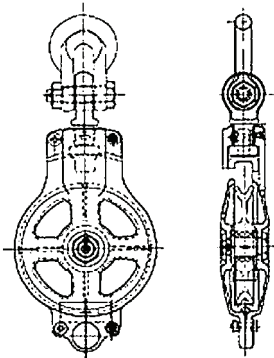

Code NO.	Type	Bracket	Sheave		Dia. W.R. (mm)	Shackle SB or BB	SWL (ton)	Weight (kg)
			Nos	Dia. (mm)				
23 15 41	1RA	W/out	Single	340	20	34	3.5	55
42				430	25	47	5.5	98
43	2RA	W/out	Double	340	20	46	13.0	105
44				430	25	60	21.0	213

Denotes, 1- Single Block, 2 - Double Block
R - With Roller Bearing
A - Without Bracket

Various Types of Blocks & Pulleys

Various sizes available upon enquiry



POLYFORM FENDER

Size	F-1	F-02	F-2
(Dia x Lgth)	6" x 24"	7.5" x 26"	8.2" x 25"
Eye Dia (cm)	1.8	1.8	2.2
Vol (L)	8.2	11.3	13.2

Size	F-3	F-4	F-5
(Dia x Lgth)	8.2" x 30"	8.5" x 40.5"	11" x 30"
Eye Dia (cm)	2.2	2.2	2.4
Vol (L)	20.0	34.9	44.9

Size	F-6	F-7	F-8
(Dia x Lgth)	11" x 42"	15" x 41"	15" x 58"
Eye Dia (cm)	2.4	2.4	2.4
Vol (L)	74.8	94.8	149.7

Size	F-10	F-11	F-13
(Dia x Lgth)	18" x 50"	21.2" x 57.5"	29" x 76.5"
Eye Dia (cm)	2.4	2.7	3.0
Vol (L)	154.2	240.4	598.7



POLYFORM BUOY

Size	A-0	A-1	A-2	A-3
(Dia x Lgth)	8" x 11.5"	11" x 15"	14.5" x 19.5"	17" x 23"
Eye Dia (cm)	1.6	2.5	2.8	2.8
Vol (L)	5.9	13.2	30.8	54.9

Size	A-4	A-5	A-6	A-7
(Dia x Lgth)	20.5" x 27"	27" x 36"	34" x 44"	39" x 54"
Eye Dia (cm)	2.8	3.0	3.8	5.0
Vol (L)	84.8	179.6	359.2	610.1



Zinc Anodes, Fenders & Buoys

Zinc Anodes



Supply of marine cathode protection systems including both galvanic and impressed current systems as well as electrolytic anti-foul systems.

Offers full range of marine galvanic anodes.

Our customers include major oil companies, independent tanker operators, bulk carriers and general cargo ship owners.

Fenders & Buoys



Supply of various marine fenders and buoys.

For short term services, we provide rental as well.

Special sizes can be manufactured according to customer's requirements.

Towing

Deep Sea Anchor Deployment

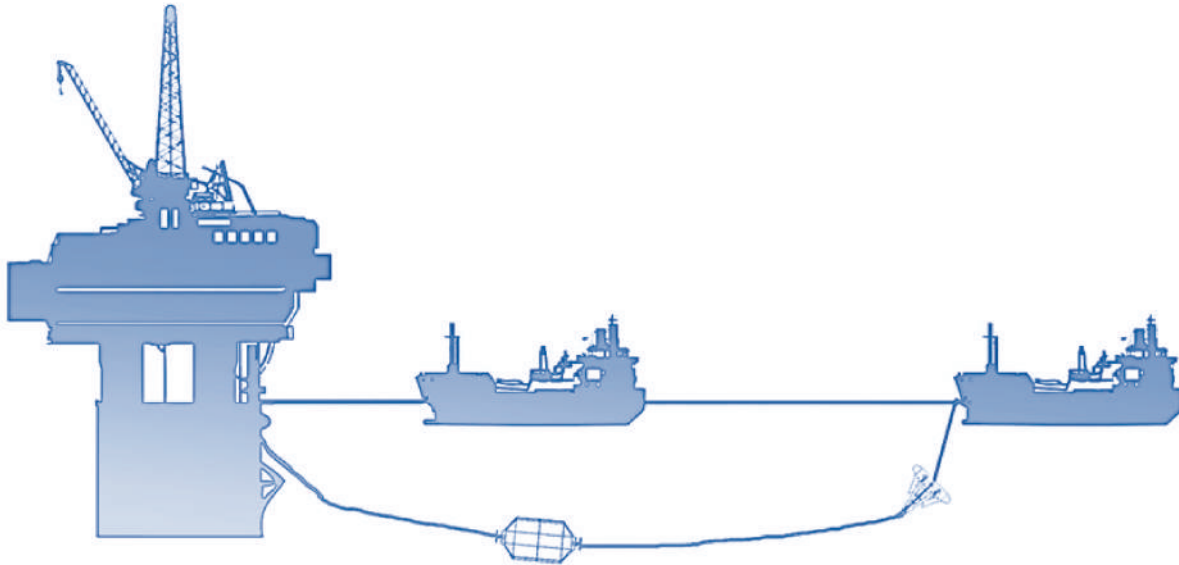

Typical Towing Arrangement

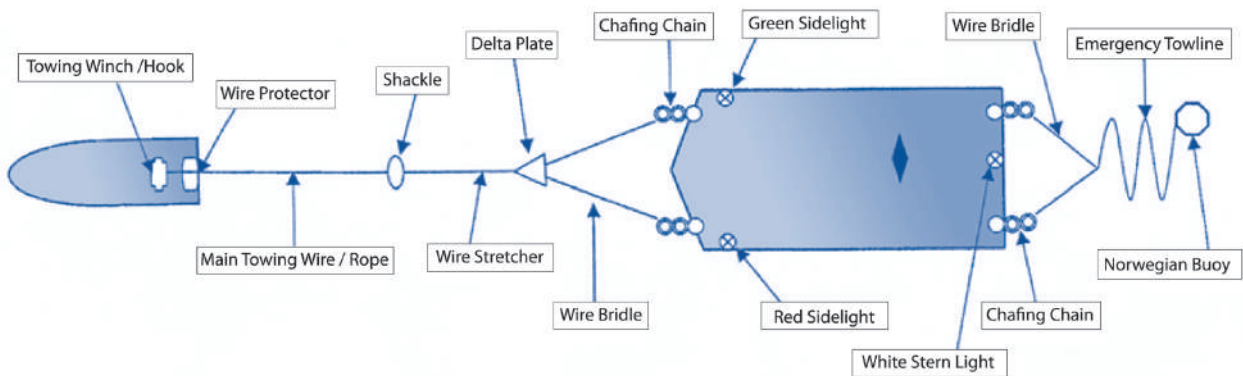

TOWING SLEEVES

Rope Dia (mm)	Inner Dia (mm)	Outer Dia (mm)	Length (m)
36	47	122	2, 3
42	56	122	2, 3
44 - 50	60	122	2, 3
54	62	122	2, 3
56	68	122	2, 3
60	72	122	2, 3
64	78	122	2, 3
68	78	165	2, 3
72 - 76	84	165	2, 3

TOWING SHOES

Rope Dia (mm)	Nominal Size (mm)	Length (m)
44	230 x 155	2, 3
52	230 x 155	2, 3
56	230 x 155	2, 3
64	230 x 155	2, 3
68	230 x 155	2, 3
70	230 x 155	2, 3
76	230 x 155	2, 3



Since 1995, we have been the
market leader for speed,
selection, quality and value

www.cncit.com.sg

C & C International Trading Pte Ltd

32 Benoi Place

Singapore 629949

T: +65 6262 1223

F: +65 6262 1938

E: enquiry@cncit.com.sg

